

19/50 Roslyn Gdns, Elizabeth Bay, NSW 2011

Sold - 12/09/2017

Apartment 1  1 



"Aquarius" Strata Studio with Parking

Enter this famous Harry Seidler apartment building to discover this North/East facing Strata Security Studio with a lovely leafy outlook over the beautifully maintained pool and bbq area. The apartment has a combined living /bedroom area, built-ins, a galley kitchen and a full bathroom with shower over the bath. Common area security parking is plentiful and the building is located close to shops, transport and Rushcutters Bay Park, Marina and tennis courts.

Venue: Domain Property Auction Centre, Cooleys, L1/20-26 Cross St, Double Bay

Details: Peter Delaney. Office: 02 9358 4255. Mobile: 0404 266 141

Outgoings: Strata Rates: \$1,255.74pq

Water Rates: \$ 177.96pq

Council Rates: \$ 250.00pq

Strata Managing Agent: Alldis & Cox: 02 9326 4488

Open for Inspection

By Appointment.

Property Features

- Stunning leafy outlook
- Common Area Security Parking
- Fabulous Pool and BBQ area
- Built -ins
- Combined living & bedroom
- Galley Kitchen

Listed By



Peter Delaney
Phone: (02) 9358 4255
Mobile: 0404266141



Floorplan

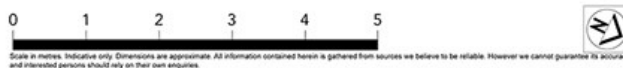
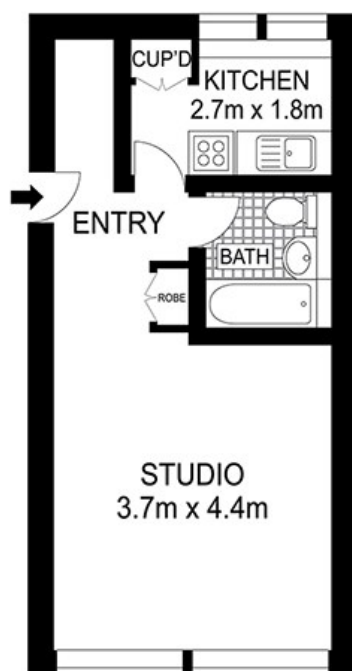

19/50 Roslyn Gardens, Elizabeth Bay